

MUI Corrosion Monitoring System

Existing Concrete Structure

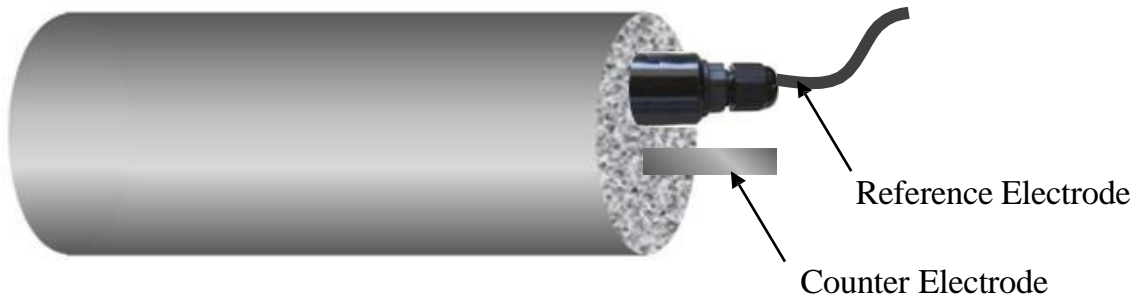

LPR Corrosion Monitoring System is to monitor the rebar corrosion condition of existing concrete structures. By installing precast LPR Probe in a core hole, the variations of the corrosion rate surrounding the LPR probe can be measured. LPR Monitoring System is useful to determine:

- Initiation of structure rebar corrosion
- Performance of non-electrochemical corrosion control measures (e.g., corrosion inhibitor, coating, penetrating sealer, waterproof membrane, etc.)

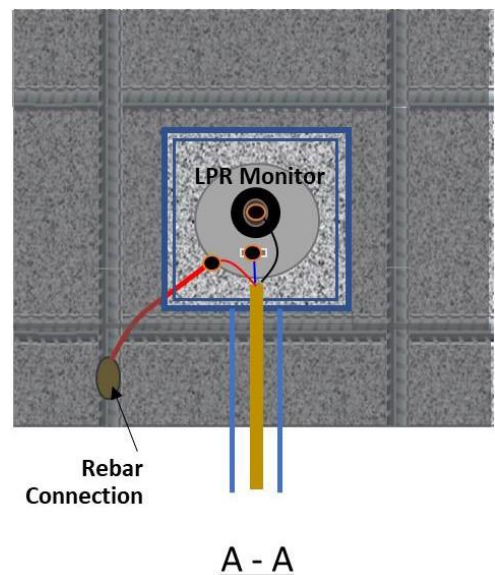
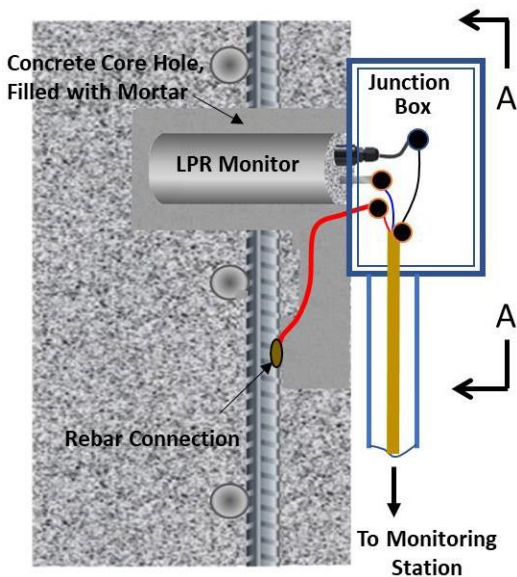

A - A

